



**Business
Telecommunication
Systems**

549 Bateman Circle • Corona, CA 92878
(951) 272-3100
www.bts1981.com

Smart Business Phone

ZIP 49GA



Quick Start Guide

Packaging Contents

The following items are included in your package. If you find anything missing, contact your system administrator.

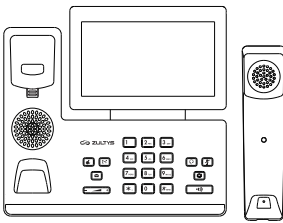

IP Phone

Handset



Handset Cord



Ethernet Cable
(2m CAT5E FTP cable)



Quick Start Guide



Power Adapter
(Optional)

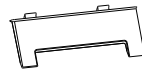

Stand



Camera
(Optional)

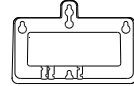

Wall Mount Bracket
(Optional)

Note: The USB camera is an optional accessory for the ZIP 49GA IP phone. We recommend the use of accessories provided or approved by ZULTYS. The use of unapproved third-party accessories may result in reduced performance or damage.

Assembling the Phone

1. Insert the optional camera, as shown below:

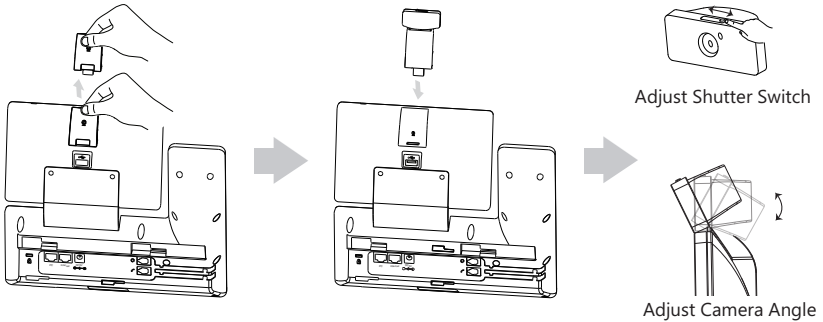

Note: The optional camera can only be connected to the USB port on the top of the phone.

2. Attach the stand and adjust the angle of touch screen, as shown below:

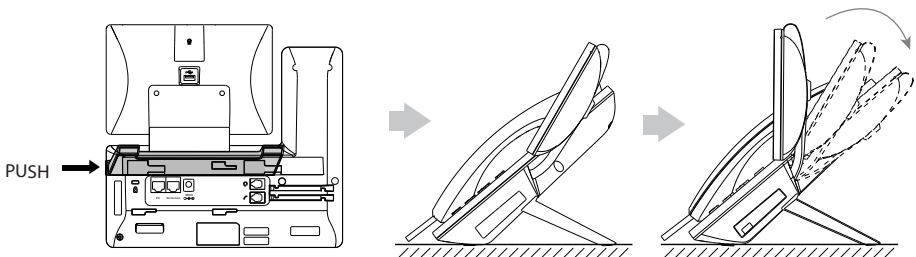

3. Attach the optional wall mount bracket, as shown below:

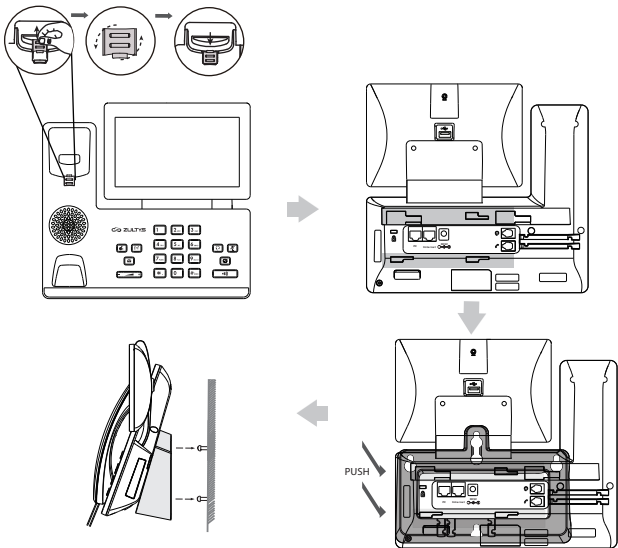

Note: The reversible tab has a lip which allows the handset to stay on-hook when the phone is mounted vertically.

4. Connect the handset and optional headset, as shown below:

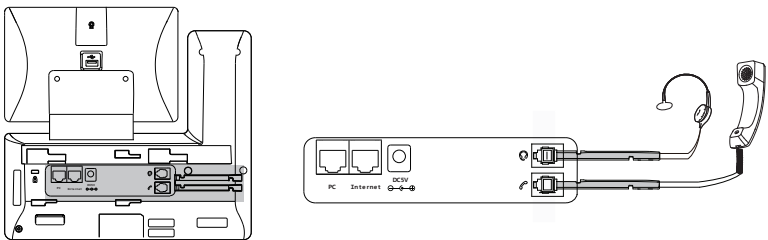

Note: Headset purchased separately. The ZIP 49GA may also be used with compatible Bluetooth & USB headsets

5. An optional USB flash drive may be connected as shown below:

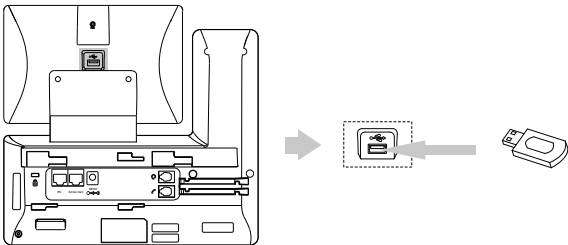

Note: The USB port (on the rear of the phone) can also be used to connect ZIP 450M Expansion Modules or a compatible USB headset.

6. Connect the power adapter or PoE, as shown below:

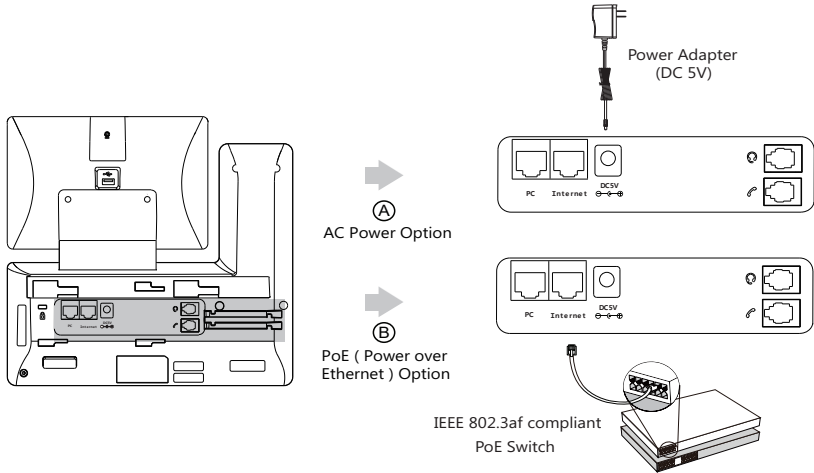

Note: The IP phone should be used with a ZULTYS original power adapter (5V/2A) only or connected to an IEEE 802.3af compliant PoE switch. The use of a third-party power adapter may cause damage.

7. Connect to the network, as shown below:

There are two options for network connection. Your system administrator will advise you which one to use.

a) Connect to the wired network:

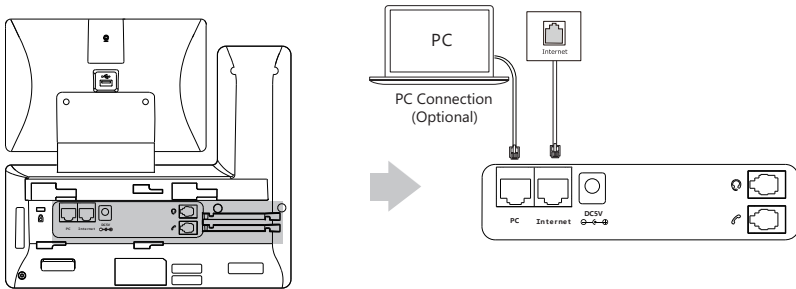

Note: If you are connecting a PC to your phone, we recommend that you use the Ethernet cable provided by ZULTYS.

b) Connect to the wireless network (Phone must be connected to a power adapter):

- 1) Swipe down from the top of the screen to enter the control center.
- 2) Tap **Settings->Basic Settings->Wi-Fi**.
- 3) Enable the Wi-Fi option.

The phone will automatically search for available wireless networks in your area.

- 4) Select an available wireless network from the list of networks.
- 5) If the network is secure, enter its password in the **Password** field.
- 6) Tap **Connect** to connect to the wireless network.

Hardware Components

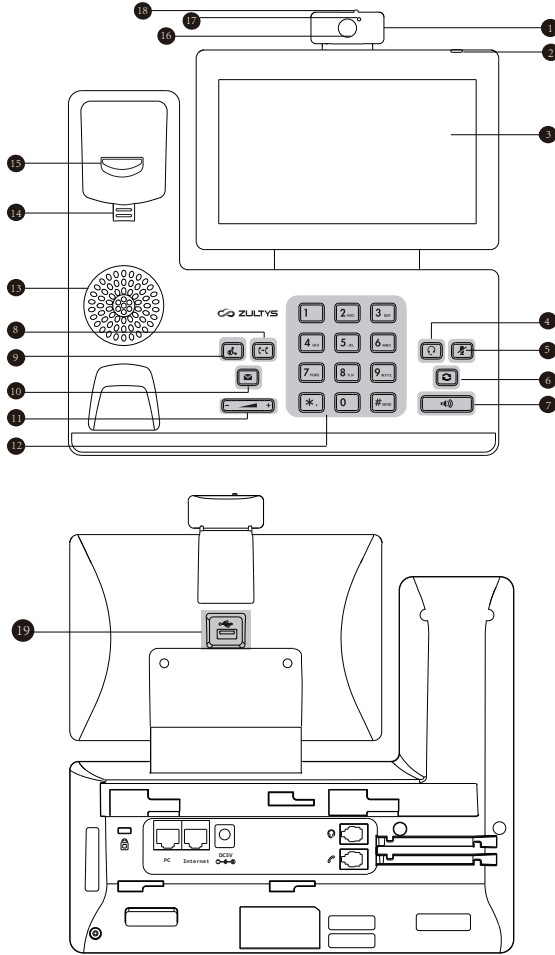

Item	Item	Item
1 Camera	8 TRANSFER Key	15 Hookswitch
2 Power Indicator LED	9 HOLD Key	16 Camera Lens
3 Touch Screen	10 MESSAGE Key	17 Camera Indicator LED
4 HEADSET Key	11 Volume Key	18 Shutter Switch
5 MUTE Key	12 Keypad	19 USB2.0 port
6 REDIAL Key	13 Speaker	
7 Speakerphone Key	14 Reversible Tab	

Startup

After the IP phone is connected to the network and supplied with power, it automatically begins a process of initializing on the network and downloading its configuration information.

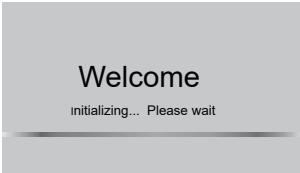

Register status icons on the touch screen:















-  (Green) Registered
-  (Gray) Register Failed
-  (Green and Flashing) Registering

Note: Contact your system administrator if the phone fails to register with the IP phone system.

Using Your Phone

Status Icons

The icons on the status bar of the touch screen provide information about phone:

Icons	Description
	Shows that camera is not detected.
 (White)	Shows that Wi-Fi is turned on.
 (Green)	Shows that the phone is connected to wireless network successfully.
	Shows that wired network is unavailable.
 (White)	Shows that Bluetooth is turned on.
 (Green)	Shows that Bluetooth headset is paired successfully.
 (Green)	Shows that Bluetooth-Enabled mobile phone is paired successfully.
	Shows that the phone is locked.
	Shows that "Forward" is turned on.
	Shows that "Do Not Disturb" is turned on.
	Shows that "Auto Answer" is turned on.
	Shows that you have missed calls.
	Shows that you have unread voice mails.
	Shows that ringer volume is set to "Silent".
	Shows that a USB flash drive is detected.

Using the Touch Screen

By default, the IP phone supports three idle screens. The home screen displays as below:



- Swipe left or right to switch among different idle screens.

To change the wallpaper:

1. Long tap an empty spot on the idle screen.
2. Tap **WALLPAPERS**.
3. Select a desired picture.
4. Tap **Set wallpaper**.

To add a widget to the idle screen:

1. Long tap an empty spot on the idle screen.
2. Tap **WIDGETS**.
3. Drag the desired widget up/down/left/right to the desired destination on the idle screen.

Control Center and Notification Center

Swipe down from the top of the screen to enter the control center and the notification center.

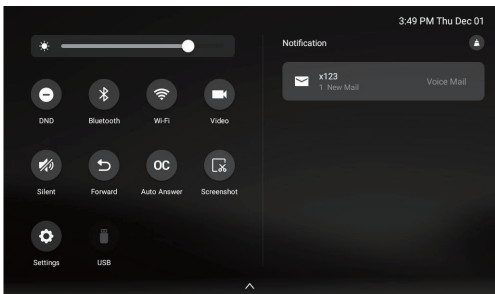

Control Center (Left)

- To turn on/off common functions quickly, capture a screenshot or go to the Settings screen, tap corresponding icons.
- To adjust the screen brightness, drag the slider.

Notification Center (Right)

Notification center displays the list of Notifications, Missed Calls, Voice Mails and Call Forward status.

- To delete all notifications, tap the broom icon.
- To delete a specific notification, swipe left.
- To view the details, tap the desired notification message.

Swipe up from the bottom of the screen to hide this screen.

Entering and Updating Data

To use onscreen keyboard:

1. Tap the input field, the onscreen keyboard will display on the touch screen:



To use keypad:

Dial or enter number.

To select a field option:

Tap the field name, tap the desired option in the pop-up dialog box.

Basic Call Features

Placing a Call

Using the handset:

1. Pick up the handset.
 2. Enter the number and then press **Send** or the **Handset icon**.
- Alternatively-- Enter the number and then lift the handset to initiate the call.

Using the speakerphone:

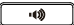
1. With the handset on-hook, enter the number.
2. Then press  or the **Handset icon**.

Using the headset:

1. With the headset connected, press  to activate the headset mode.
2. Enter the number and then press **Send** or the **Handset icon**.

Answering a Call

Using the handset:

Pick up the handset.

Using the speakerphone:

Press  or the **Answer** soft key.

Using the headset:

Press  or the **Answer** soft key if headset mode is active.

Controlling call during a Video Call

To display call control icons:

- Tap the screen to display the call control icons.
- Tap the screen again to hide the call control icons or wait until they clear after a short period.

To turn on/off near-end video during a call:

Tap the screen to display the call control icons, then press the **More** button. Press **Camera Mute** to stop sending your video.

Ending a Call

Using the handset:

Hang up the handset or tap the **End Call** soft key.



Using the speakerphone:

Press  or tap the **End Call** soft key.



Using the headset:

Tap the **End Call** soft key.

Redial

- Press  to enter the **Placed Calls** list, tap the desired entry and select Audio Call or Video Call.
- Press  twice when the phone is idle to call the last dialed number.

Call Mute and Un-mute

- Press  to mute the microphone during a call.
- Press  again to un-mute the call.

Call Hold and Resume

To place a call on hold:

Press  or tap the **Hold** soft key during an active call.



To resume the call, do one of the following:

- If there is only one call on hold, press  or tap the **Resume** soft key.
- If there is more than one call on hold, tap the Calls icon, then press **Resume** on the call to be retrieved from hold.



Call Transfer

You can transfer a call in the following ways:

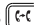

Blind Transfer

1. Press  or tap the **Transfer** icon on the **More** menu during a call. The call is placed on hold.
2. Enter the number you want to transfer to.
3. Press  to complete the transfer.

Semi-Attended Transfer

1. Press  or tap the **Transfer** icon in the More menu during a call. The call is placed on hold.
2. Enter the number you want to transfer to, and then press .
3. Press  or tap the **Transfer** soft key when you hear the ring-back tone.

Attended Transfer

1. Press  or tap the **Transfer** icon during a call. The call is placed on hold.
2. Enter the number you want to transfer to, and then press .
3. Press  or tap **Transfer** soft key when ready to complete transfer. Press **End Call** to cancel.

Call Forward

To enable call forward:

1. Swipe down from the top of the screen to enter the control center.
2. Tap **Settings**->**Features**->**Call Forward**.
3. Select the desired forward type:
 - Always Forward**----Incoming calls are forwarded unconditionally.
 - Busy Forward**----Incoming calls are forwarded when the phone is busy.
 - No Answer Forward**----Incoming calls are forwarded if not answered after a period of time.
4. Enter the number you want to forward to. For **No Answer Forward**, tap the **After Ring Time** field, and then tap the desired ring time to wait before forwarding.
5. Tap  to accept the change.

Call Conference

1. During an active call, press the **+ Invite** soft key to enter the **Conference with** menu.
2. Enter the number to be dialed then press **+** to add number to **Selected Members** list, or select one or more contacts from an address book.
3. Once all numbers and contacts are added press the **Call** soft key to initiate outbound calls and conference all parties together. Up to 10 parties may be conferenced in an audio call.

Note: To conference one or more held calls press the **Calls** soft key then **Merge calls** to conference calls.

Voice Message



A Message Waiting Indicator on the idle screen indicates that one or more voice messages are waiting on the voicemail service. The power indicator LED slowly flashes red.

To listen to voice messages:

1. Do one of the following:
 - Press .
 - If the 'New Voice Mail(s)' dialog is displayed press the Connect soft key.
2. Follow the voice prompts to listen to your voice messages.



Customizing Your Phone

Call History

1. Tap , and then select the desired call list on the left.
2. Drag up and down to scroll.
3. Tap an entry to initiate a call or press the  icon to display additional information.
 - Additional actions are available via the ... icon including:
 - Add** to add the entry to the local directory.
 - Edit before calling** to edit the phone number of the entry before placing a call.
 - Blocklist** to add the entry to the blocklist.
 - Delete** to delete the entry from the list.

Contact Directory

To add a contact to Local Directory or Blocklist:

1. Tap , and then select the **Local Directory** or **Blocklist** on the left.
2. Tap  to add a contact.
3. Enter a unique contact name in the **Name** field and contact numbers in the corresponding fields.
4. Tap **OK** to accept the change.

To edit a contact in Local Directory or Blocklist:



1. Tap , and then select the desired group on the left.
2. Tap the desired contact.
3. Tap the edit icon and proceed to edit the contact information as required.
4. Tap **OK** to accept the changes.

To delete a contact from Local Directory or Blocklist:

1. Tap , and then select the desired group on the left.
2. Tap the desired contact followed by the ... icon and then tap **Delete**.
3. Tap **OK** when the touch screen prompts "Delete selected item?".

Note: You can add contacts from call history. For more information, refer to **Call History** above.

Volume Adjustment

- Press  during a call to adjust the receiver volume of the handset/speakerphone/headset.
- Press  when the phone is idle or ringing to adjust the ringer volume.
- Press  to adjust the media volume in the corresponding screen.

My Details

Name	
Extension	
DID	

ZAC Login Credentials	
Login Name (case sensitive)	
Password	
Host/URL	
Assigned Phone ID	

Support Contact	
Phone	
Email	

Notes

FCC Statement

This device complies with part 15 of the FCC Rules. Operation is subject to the following two conditions: (1) This device may not cause harmful interference, and (2) this device must accept any interference received, including interference that may cause undesired operation.

This equipment has been tested and found to comply with the limits for a Class B digital device, pursuant to part 15 of the FCC Rules. These limits are designed to provide reasonable protection against harmful interference in a residential installation. This equipment generates, uses and can radiate radio frequency energy and, if not installed and used in accordance with the instructions, may cause harmful interference to radio communications. However, there is no guarantee that interference will not occur in a particular installation. If this equipment does cause harmful interference to radio or television reception, which can be determined by turning the equipment off and on, the user is encouraged to try to correct the interference by one or more of the following measures:

- Reorient or relocate the receiving antenna.
- Increase the separation between the equipment and receiver.
- Connect the equipment into an outlet on a circuit different from that to which the receiver is connected.
- Consult the dealer or an experienced radio/TV technician for help.

IC Statement

This device complies with Industry Canada's license-exempt RSSs. Operation is subject to the following two conditions:

- (1) this device may not cause interference; and
- (2) this device must accept any interference, including interference that may cause undesired operation of the device. CAN ICES-3(B)

Le présent appareil est conforme aux CNR d'Industrie Canada applicables aux appareils radio exempts de licence. L'exploitation est autorisée aux deux conditions suivantes:

- (1) l'appareil ne doit pas produire de brouillage;
- (2) l'utilisateur de l'appareil doit accepter tout brouillage radioélectrique subi, même si le brouillage est susceptible d'en compromettre le

Radiation Exposure Statement

This equipment complies with FCC and IC radiation exposure limits set forth for an uncontrolled environment. This equipment should be installed and operated with minimum distance 20cm between the radiator and your body.

Cet émetteur ne doit pas être Co-placé ou ne fonctionnant en même temps qu'aucune autre antenne ou émetteur. Cet équipement devrait être installé et actionné avec une distance minimum de 20 centimètres entre le radiateur et votre corps.

About Zultys

Zultys is the global provider of a true all-in-one unified communications solution. Innovative, reliable and scalable, Zultys IP phone systems integrate voice, video, data and mobility in a single premise based appliance or in the cloud - to optimize collaboration for businesses of all sizes.

Zultys delivers a powerful, feature-rich communications system that is easy-to-use, deploy and maintain. Zultys is headquartered in Silicon Valley with offices around the world.

Zultys, Inc.
785 Lucerne Drive, Sunnyvale
California, 94085, USA
Copyright © 2019 Zultys, Inc.
All rights reserved